

Redevelopment of teaching facilities - work has been carried out to make sure that the main teaching facilities are safe and fully accessible for our students. We have widened corridors and repaired and replaced things like the roof and heating system, that had been in place since the college was originally built in 1970.

Phase 1 - This student residential building was opened in 2004. There are 19 rooms including 5 rooms for wheelchair users. This accommodation is home to some of our most complex students and the modern, specially designed facilities have had a major impact on the progress the students have made at Henshaws.

Phase 2 - This is the building that we need your support to finish! Once complete, it will offer accommodation for 22 students including 8 wheelchair users. There will also be two "independence" flats in this building to give students the chance to practice the life skills they have learnt at the college.

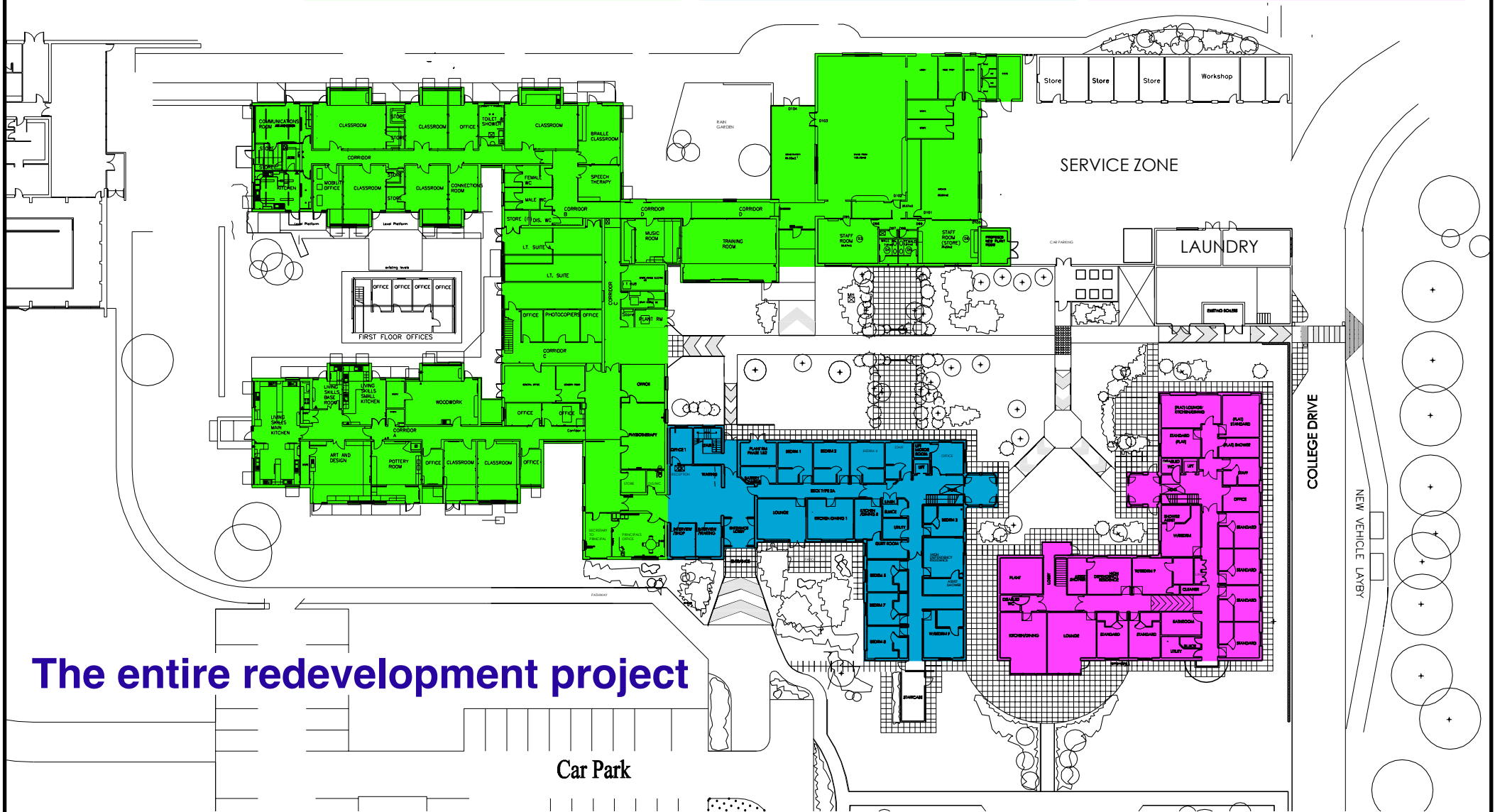

The entire redevelopment project